

SOAPOPOPULAR PLUS® 70% ALCOHOL FOAM DISPENSERS



Wall-Mount Dispensing Systems

Soapopular PLUS® Hand Hygiene products are further enhanced with the implementation of our Durable Foam Dispensers. They are designed to withstand the rigors of High-Traffic Areas by enabling facilities to increase access to Hand Hygiene products, covering more area's that are prone to germs/bacteria.

For area's with limited to no surface space, Soapopular PLUS® Dispensers can be mounted to flat wall surfaces using one of two quick and easy installation methods: Strong Adhesive Tape or by using Screws and Anchors, both parts included with all Wall-Mount Dispensers.

- Made using durable materials to handle frequent use in fast-paced environments to protect and cover more area's that are prone to germs/bacteria.
- Can be mounted to most flat-wall surfaces efficiently and easily using Strong Adhesive Tape or Screws and Anchors that are included with each Wall-Mount Dispenser.
- Soapopular PLUS® Dispensers are designed to apply Foam formula's, requiring the refilling and use of our 70% Alcohol Hand Sanitizer that is specifically formulated to Foam.
- Increasing access to Hand Hygiene products around key locations in your facility can aid in reducing the spread of germs and bacteria, promoting a clean environment.

Soapopular PLUS® Dispensers utilize one of two Refill Systems to better fulfill the needs of our users. Our Cartridge Refill and Bulk-Fill Refill System feature their own advantages and options to make implementation easier in your industry.

Cartridge Refill System

- Click-and-Go Refill
- Clean-Tip Technology
- 3,000 Applications
- 1,000mL Capacity
- Covered and No-Cover Options

Bulk-Fill Refill System

- Cost-Effective Refill
- Multi-Dispenser Refill
- 2,600 Applications
- 1,000mL Capacity
- Automatic and Manual Options

SOAPOPOPULAR PLUS® Dispensers can be used:

- Mounted in Hallways
- Lobby's and Entry-ways
- Near Doors and Elevators
- Seating and Waiting Area's
- High-Traffic Rooms and Area's

and More!

SOAPOPOPULAR PLUS® DISPENSER REFILL SYSTEM DESCRIPTION



416 979 1757



info@soapopular.com



www.soapopular.com

Soapopular PLUS® 1L Cartridge Refill System

Quick and simple, the Soapopular PLUS® Cartridge Refill System swaps out empty cartridges with newly filled ones for a seamless Refilling System. The Click-and-Go cartridges easily pop out and click into the dispenser when needed making the process hassle-free and fast for maintenance.

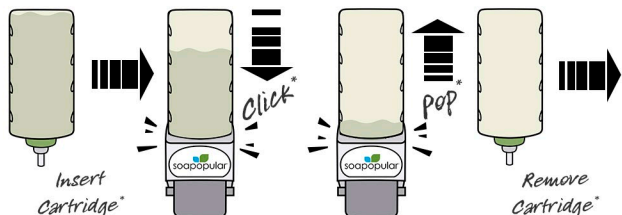

Soapopular PLUS® 4L Bulk-Fill Refill System

Cost-Effective refilling, the Soapopular PLUS® Bulk-Fill Refill System utilizes our 4L Refill Jugs that can fill up to FOUR dispensers per 4L Jug. Simply pour the contents of the Refill Jug into the Inner Dispenser Bottle when needed. Dispensers used with this Refill System are available in Manual and Automatic.



Soapopular PLUS® 70% Alcohol Foam No-Cover Dispenser - 1000mL

Product Code: 57111-NC
Volume/Size: 1000mL/33.4 fl oz
Applications: 3,000
Formulation: Foam
Material: Durable Plastic
Colour: White
Unit Weight: 0.70 lbs

Units per Case: 6
Case Dimensions: 11.50in x 11.50in x 6.00in
Cases per Pallet: 108
Case Weight: 4.60 lbs



Soapopular PLUS® 70% Alcohol Foam Manual Bulk-Fill Dispenser - 1000mL

Product Code: 57106
Volume/Size: 1000mL/33.4 fl oz
Applications: 2,600
Formulation: Foam
Material: Durable Plastic
Colour: White
Unit Weight: 1.50 lbs

Units per Case: 12
Case Dimensions: 21.00in x 16.00in x 12.00in
Cases per Pallet: 24
Case Weight: 21.0 lbs



Soapopular PLUS® 70% Alcohol Foam Covered Dispenser - 1000mL

Product Code: 57111
Volume/Size: 1000mL/33.4 fl oz
Applications: 3,000
Formulation: Foam
Odour/Scent: Durable Plastic
Colour: Translucent White
Unit Weight: 0.90 lbs

Units per Case: 6
Case Dimensions: 15.00in x 12.50in x 9.50in
Cases per Pallet: 81
Case Weight: 5.85 lbs



Soapopular PLUS® 70% Alcohol Foam Auto. Bulk-Fill Dispenser - 1000mL

Product Code: 57002
Volume/Size: 1000mL/33.4 fl oz
Applications: 2,600
Formulation: Foam
Material: Durable Plastic
Colour: White
Unit Weight: 1.90 lbs

Units per Case: 12
Case Dimensions: 21.00in x 16.00in x 12.00in
Cases per Pallet: 24
Case Weight: 25.0 lbs



Soapopular PLUS® 70% Alcohol Foam Cartridge Refill - 1000mL

Product Code: 57000
Volume/Size: 1000mL/33.4 fl oz
Applications: 3,000
Formulation: Foam

Order Product Cartridge Refill (68000) to properly refill Soapopular Covered & No Cover Dispensers.



Soapopular PLUS® 70% Alcohol Foam Bulk-Fill Refill - 4L

Product Code: 57400
Volume/Size: 4L/1.05 gal.
Applications: 10,000
Formulation: Foam

Order Product Bulk-Fill Refill (68019) to properly refill Soapopular Manual & Automatic Dispensers.



Cartridge Clean-Tip Technology

Each Cartridge used to Refill the Covered and No-Cover Dispensers are equipped with Clean-Tip Technology that eliminates wasteful leaks and drips by pulling formula back into the pump after each application.



Automatic Dispenser Available in 3 Colours

Soapopular PLUS® Automatic Foam Dispenser is available in 3 different colours that features an Infrared Sensor, applying a controlled amount of product without having to touch the dispenser.