

SOAPOPOPULAR® ANTIBACTERIAL FOAM DISPENSERS



Wall-Mount Dispensing Systems

Soapopular® Hand Hygiene products are further enhanced with the implementation of our Durable Foam Dispensers. Designed to withstand the rigors of High-Traffic Areas, our dispensers enable facilities to increase access to Hand Hygiene products by covering more area's that are prone to germs/bacteria.

For area's with limited to no counter/table space, Soapopular® Dispensers can be mounted to flat wall surfaces using one of two quick and easy installation methods: Strong Adhesive Tape or by using Screws and Anchors, both parts included with all Wall-Mount Dispensers.

- Made using durable materials to handle frequent use in fast-paced environments to protect and cover more area's that are prone to germs/bacteria.
- Can be mounted to most flat-wall surfaces efficiently and easily using Strong Adhesive Tape or Screws and Anchors that are included with each Wall-Mount Dispenser.
- Soapopular® Dispensers are designed to apply a Foaming formula, requiring the use of our Antibacterial Hand Soap that is specifically formulated to Foam.
- Increasing access to Hand Hygiene products around key locations in your facility can aid in reducing the spread of germs and bacteria, promoting a clean environment.

Soapopular® Dispensers utilize one of two Refilling Systems to better fulfill the needs of our users. Our Cartridge Refill and Bulk-Fill Refill System feature their own advantages and options to make implementation easier in our industry.

Cartridge Refill System

- Click-and-Go Refill
- Clean-Tip Technology
- 3,000 Applications
- 1,000mL Capacity
- Covered and No-Cover Options

Bulk-Fill Refill System

- Cost-Effective Refill
- Multi-Dispenser Refill
- 2,600 Applications
- 1,000mL Capacity
- Automatic and Manual Options

SOAPOPOPULAR® Foam Dispensers can be used:

- Mounted in Washrooms
- Cafeteria's and Kitchens
- Hand Washing Stations
- Close to area's with a Sink

and More!

SOAPOPOPULAR® DISPENSER REFILL SYSTEM DESCRIPTION

Soapopular® 1L Cartridge Refill System

Quick and simple, the Soapopular® Cartridge Refill System swaps out empty cartridges with newly filled ones for a seamless Refilling System. The Click-and-Go cartridges easily pop out and click into the dispenser when needed making the process hassle-free and fast for maintenance.

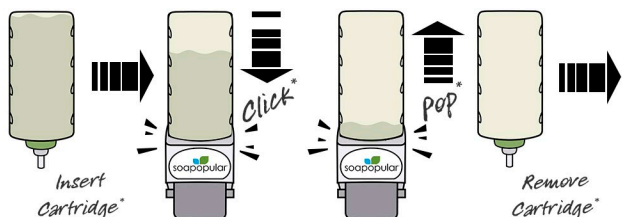

Soapopular® 4L Bulk-Fill Refill System

Cost-Effective refilling, the Soapopular® Bulk-Fill Refill System utilizes our 4L Refill Jugs that can fill up to FOUR dispensers per 4L Jug. Simply pour the contents of the Refill Jug into the Inner Dispenser Bottle when needed. Dispensers used with this Refill System are available in Manual and Automatic.



Soapopular® Antibacterial Foam No-Cover Dispenser - 1000mL

Product Code:	10111-NC	Units per Case:	6
Volume/Size:	1000mL/33.4 fl oz	Case Dimensions:	11.50in x 11.50in x 6.00in
Applications:	3,000	Cases per Pallet:	108
Formulation:	Foam	Case Weight:	4.60 lbs
Material:	Durable Plastic		
Colour:	White		
Unit Weight:	0.70 lbs		



Soapopular® Antibacterial Foam Manual Bulk-Fill Dispenser - 1000mL

Product Code:	10106	Units per Case:	12
Volume/Size:	1000mL/33.4 fl oz	Case Dimensions:	21.00in x 16.00in x 12.00in
Applications:	2,600	Cases per Pallet:	24
Formulation:	Foam	Case Weight:	21.0 lbs
Material:	Durable Plastic		
Colour:	White		
Unit Weight:	1.50 lbs		



Soapopular® Antibacterial Foam Covered Dispenser - 1000mL

Product Code:	10111	Units per Case:	6
Volume/Size:	1000mL/33.4 fl oz	Case Dimensions:	15.00in x 12.50in x 9.50in
Applications:	3,000	Cases per Pallet:	81
Formulation:	Foam	Case Weight:	5.85 lbs
Odour/Scent:	Durable Plastic		
Colour:	Translucent White		
Unit Weight:	0.90 lbs		



Soapopular® Antibacterial Foam Auto. Bulk-Fill Dispenser - 1000mL

Product Code:	10002	Units per Case:	12
Volume/Size:	1000mL/33.4 fl oz	Case Dimensions:	21.00in x 16.00in x 12.00in
Applications:	2,600	Cases per Pallet:	24
Formulation:	Foam	Case Weight:	25.0 lbs
Material:	Durable Plastic		
Colour:	White		
Unit Weight:	1.90 lbs		



Soapopular® Antibacterial Foam Cartridge Refill - 1000mL

Product Code:	10000	Order Product Cartridge Refill (10000) to properly refill Soapopular Covered & No Cover Dispensers.
Volume/Size:	1000mL/33.4 fl oz	
Applications:	3,000	
Formulation:	Foam	



Soapopular® Antibacterial Foam Bulk-Fill Refill - 4L

Product Code:	10004	Order Product Bulk-Fill Refill (10004) to properly refill Soapopular Manual & Automatic Dispensers.
Volume/Size:	4L/1.05 gal.	
Applications:	10,000	
Formulation:	Foam	



Cartridge Clean-Tip Technology

Each Cartridge used to Refill the Covered and No-Cover Dispensers are equipped with Clean-Tip Technology that eliminates wasteful leaks and drips by pulling formula back into the pump after each application.



Automatic Dispenser Available in 3 Colours

Soapopular® Automatic Foam Dispenser is available in 3 different colours that features an Infrared Sensor, applying a controlled amount of product without having to touch the dispenser.